

CONCRETE, COMPRESSED CEMENT SHEET

LIQUID FLASH 2 PACK

PACKAGING

MIXING



APPLICATION



ADHERING TILES

KEMFLEX 2:1 ACOUSTIBOND

PACKAGING

MIXING



APPLICATION



SUBSTRATES

CONCRETE
COMPRESSED
CEMENT SHEET

Decking to be fixed in accordance with local building codes and the manufacturers fixing instructions and good trade practice.

MATERIALS:

LIQUID FLASH 2 PACK is a two pack acrylic waterproofing membrane available from Construction Chemicals. KEMFLEX 2:1 and ACOUSTIBOND are two pack adhesives.

SURFACE PREPARATION:

The structure must be firm, sound and clean, free from grease, dust, coatings and other contaminants. Abrade or sand contaminated surfaces to provide a totally clean surface.

DECK DESIGN:

To make to deck waterproof it must be:

- Rigid and not flexing.
- Falls to drain (no ponding). Minimum fall 1 : 100.
- Outlet and overflow be designed to suit expected water flow.
- The membrane to be turned up 150mm at wall junction to stop water penetration.
- A 100mm step from the tiled deck to door and window junction/lintels.

WORKMANSHIP:

Apply products in accordance with the manufacturers written instructions and good trade practice.

APPLICATION:

Waterproofing - Apply in accordance with AS3740

Apply bond breaker at all sheet junctions and wall/deck junctions.

LIQUID FLASH 2 PACK – reinforce into the first wet coat with 140mm REOMAT at sheet junctions and wall/deck junctions.

Apply two coats of LIQUID FLASH 2 PACK to a minimum dry film thickness of 1.5mm.

THICKNESS

Check the wet film thickness at 0.5 metre intervals and also at 0.5 metres along the bond breaking tape, with a wet film thickness gauge.

Adhering Ceramic Tiles

Fix tiles with KEMFLEX 2:1 or when acoustic performance is required with ACOUSTIBOND.

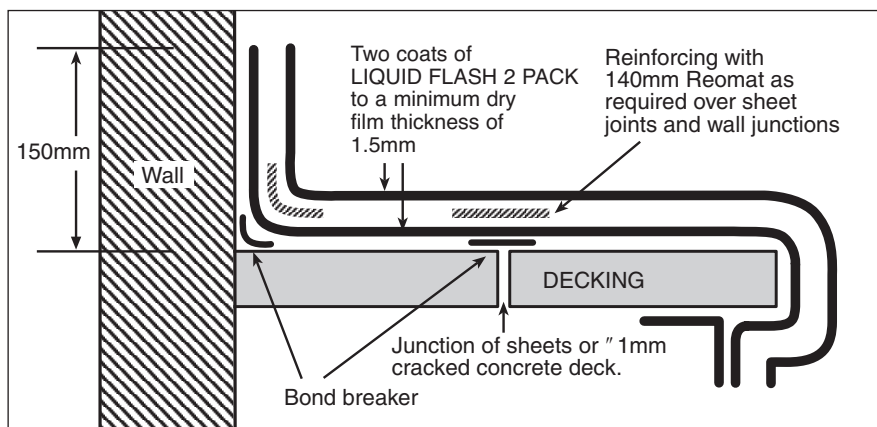

**CONSTRUCTION
CHEMICALS**

- **ADELAIDE** 135 CORMACK RD (Cnr Davis Rd) WINGFIELD 5013 PH: (08) 8243 7888 FAX: (08) 8243 7800
- **BRISBANE** 45 COULSON ST WACOL 4076 PH: (07) 3271 2944 FAX: (07) 3271 3892
- **MELBOURNE** 11 GABRIELLE CT BAYSWATER NORTH 3153 PH: (03) 9761 4711 FAX: (03) 9761 4748
- **PERTH** 11 COLLIE ST WELSHPOOL 6106 PH: (08) 9356 9999 FAX: (08) 9356 9955
- **SYDNEY** 31-33 NEWTON RD WETHERILL PARK 2164 PH: (02) 9756 3533 FAX: (02) 9756 3534
- **AUCKLAND** 16 CARPENTER RD EAST TAMAKI PH: (09) 273 5444 FAX: 0800 266 236
- **KUALA LUMPUR** LOT 2 JALAN KECAPI 33/2 ELITE INDUSTRIAL ESTATE OFF JALAN BUKIT KEMUNING 40000 SHAB ALAM PH: (603) 5122 2522 FAX: (603) 5122 2526

www.constructionchemicals.com.au

"The information contained in this technical publication is based on our current knowledge and experience and is provided as a guide only. In view of the many factors that may affect application it is the users sole responsibility to ensure suitability for a specific purpose."